

LA NOSTRA GAMMA DI PRESE DI SERVIZIO

Our range of panel mounting connectors

Prese di servizio a pannello disponibili
in versioni Ø 16, 20 e 22.

Tappo con grado di protezione IP65/ IP67.

*Panel service sockets available
in Ø 16, 20, 22 versions.*

Cap with IP65/IP67 protection degree.



PRESE A PANNELLO Ø 16 E 20 CON CAVO PRECABLATO DEDICATO IP67

*Panel sockets ø 16 and 20
with dedicated pre-wired cable ip67*

Disponibili cavi precablati da abbinare alle prese di servizio a pannello Ø 16 e 20. Il grado di protezione IP 67 è garantito sia con che senza connettore.

Pre-wired cables available to match the Ø 16 and 20 panel service sockets. The IP 67 protection degree is guaranteed both with and without connector.



PRESE DI SERVIZIO A PANNELLO Ø22

Panel mounting connectors Ø22 mm

Sistemi di connessione

Connection systems

Corpo in alluminio - plastica / Aluminium - plastic body
Tappo IP65 incluso / IP65 cap included

IP65

RoHS
COMPLIANT

CE



Specifiche tecniche / Technical features

Diametro foratura Diameter cut-out	Materiale Material	Spessore Lamiera Panel thickness	Temperatura operativa Operative temperature	Umidità operativa Operating humidity	Velocità di trasmissione / transmission rating		
					USB2.0/USB Mini/ Micro - USB	USB 3.0	USB - C
22 mm	Metallo / Metal Plastica / Plastic	1 - 10 mm	-25 ... +55°C	45-85%RH	>30MB/s	>100MB/s	10GBps (5A fast charging)

MODELLI Model list	Tipo / fronte Type / front	Tipo / retro Type / back	Modello Model list	Codice Code	Descrizione Description
	RJ45 Cat.6 Femmina Female	RJ45 Cat.6 Femmina Female	PS-P22MR45	4302212185	Pres a pannello RJ45 cat.6 plastica F/F Panel RJ45 Cat.6 plastic connector F/F
	USB 3.0 Femmina Female	USB 3.0 Femmina Female	PS-P22PU3	4302212110	Pres a pannello USB 3.0 plastica F/F Panel USB 3.0 Cat.6 plastic connector F/F
	USB-B Femmina Female	USB-A Femmina Female	PS-P22PUB	4302212120	Pres a pannello USB-B plastica F/F (Retro USB-A) Panel USB-B plastic connector F/F (Rear USB-A)
	USB-C Femmina Female	USB 3.0 Femmina Female	PS-P22MUC	4302212150	Pres a pannello USB-C F/F Metallo (Retro USB 3.0) Panel USB-C metal connector F/F (Rear USB 3.0)
	USB-Mini 2.0 Femmina Female	USB-Mini 2.0 Maschio Male	PS-P22MMIU	4302212160	Pres a pannello USB-Mini F/M Metallo Panel USB-Mini metal connector F/M
	USB-Micro 2.0 Femmina Female	USB-Micro 2.0 Maschio Male	PS-P22MMOU	4302212170	Pres a pannello USB Micro F/M Metallo Panel USB-Micro metal connector F/M
	HDMI Femmina Female	HDMI Femmina Female	PS-P22MH	4302212190	Pres a pannello HDMI F/F Metallo Panel HDMI metal connector F/F
	2 x USB 2.0 Femmina Female	2 x USB 2.0 Femmina Female	PS-P22MU2X2	4302212300	Pres a pannello 2 x USB 2.0 F/F ø 22 mm in metallo Panel 2 x USB 2.0 metal connector F/F ø 22 mm
	-	-	PS-T22IP65	4302212200	Tappo nero IP65 per presa a pannello ø 22 mm Ip65 cap for panel mounting ø 22 mm

TAPPO COMPRESO NELLA FORNITURA DELLA PRESA A PANNELLO / PROTECTION CAP INCLUDED WITH THE PANEL CONNECTOR

Dimensionali e forature / Dimensions and holes

RJ45 Cat.6 - Mod. PS-P22MR45

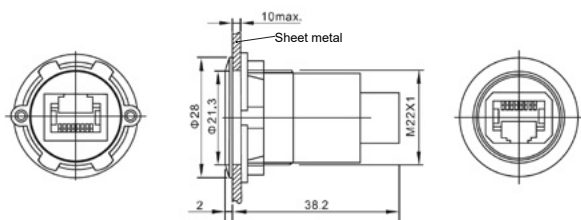

USB-Mini 2.0 - Mod. PS-P22MMIU

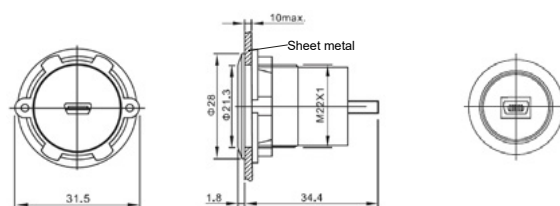

USB 3.0 - Mod. PS-P22PU3

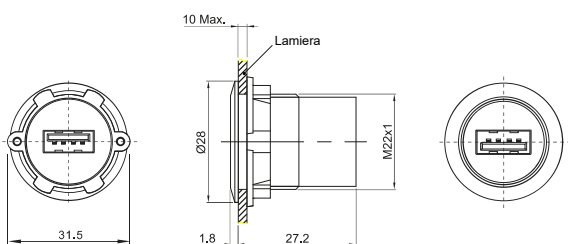

USB-Micro 2.0 - Mod. PS-P22MMOU

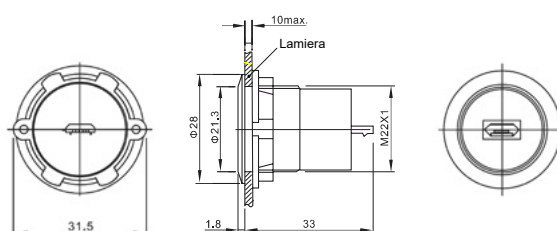

USB-B - Mod. PS-P22PUB

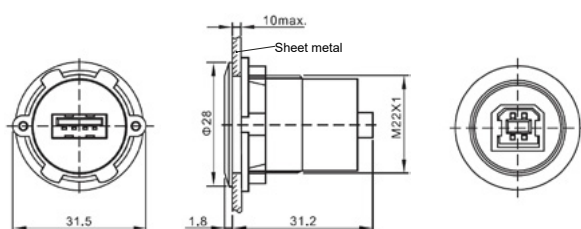

HDMI - Mod. PS-P22MH

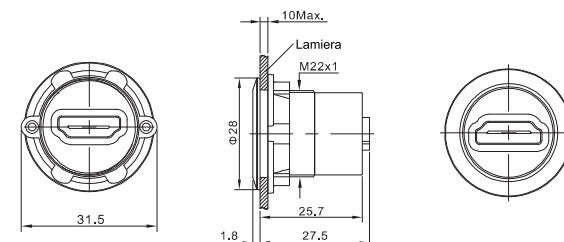

USB-C - Mod. PS-P22MUC

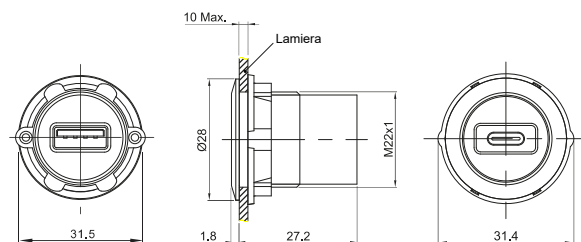

2 x USB 2.0 - Mod. PS-P22MU2X2

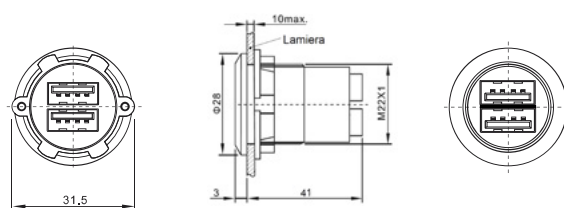

TAPPO IP65 - Mod. PS-T22IP65

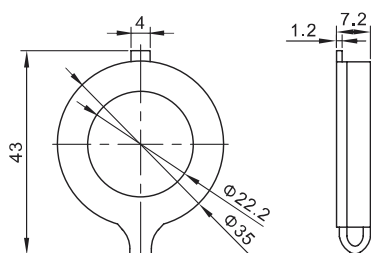

PRESE DI SERVIZIO A PANNELLO Ø20 E Ø16

Panel mounting connectors Ø20 and Ø20



Sistemi di connessione
Connection systems

Corpo in plastica / Plastic body
Tappo IP67 incluso / IP67 cap included

IP67

RoHS
COMPLIANT

CE



Specifiche tecniche / Technical features

Diametro foratura Diameter cut-out	Materiale Material	Spessore Lamiera Panel thickness	Temperatura operativa Operative temperature	Umidità operativa Operating humidity	Velocità di trasmissione / transmission rating		
					USB2.0/USB Mini/ Micro - USB	USB 3.0	USB - C
20 e 16 mm	PA66	1 - 4 mm	-40 ... +80°C	45-85%RH	>30MB/s	>100MB/s	10GBps (5A fast charging)

MODELLI Model list	Tipo / fronte Type / front	Tipo / retro Type / back	Modello Model list	Codice Code	Descrizione Description
	Femmina / Female RJ45	Femmina / Female RJ45	PS-P20PR45	4302212480	Pres a pannello in plastica RJ45 cat.6a F/F Panel RJ45 Cat.6A plastic connector F/F
	Femmina / Female USB 3.0	Femmina / Female USB 3.0	PS-P20PU3	4302212410	Pres a pannello in plastica USB 3.0 F/F Panel USB 3.0 plastic connector F/F
	Femmina / Female HDMI	Maschio / Male HDMI	PS-P20PH	4302212490	Pres a pannello in plastica HDMI F/F Panel HDMI plastic connector F/F
	Femmina / Female USB-C	Femmina / Female USB-C	PS-P16PUC	4302212450	Pres a pannello in plastica USB-C F/F Panel USB-C plastic connector F/F

MODELLI Model list	Tipo / lato A Type / side A	Tipo / lato B Type / side B	Lunghezza Length	Codice Code	Modello Model	Descrizione Description
 NEW	Maschio / Male USB C	Maschio / Male USB 3.0	2 m	4302212455	PS-C16PUC320	Cavo USB-C M/M 2 m per PS-P16PUC USB-C M/M cable 2 m for PS-P16PUC
 NEW	Maschio / Male USB 3.0	Maschio / Male USB 3.0	2 m	4302212415	PS-C20PU320	Cavo USB3.0 M/M 2 m per PS-P20PU3 USB3.0 M/M cable 2 m for PS-P20PU3
 NEW		Cavo non incluso Cable not included		4302212475	PS-C20PR45	Custodia waterproof per cavo RJ45 standard per PS-P20PR45. Cavo non incluso. Waterproof housing for RJ45 cable for PS-P20PR45. Cable not included.